

HH012

Installation method		Application	
Floor	●	Spot welding	
Ceiling		Arc welding	
Wall surface		Handling	●
		Assembly	●
		Sealing	
		Painting	

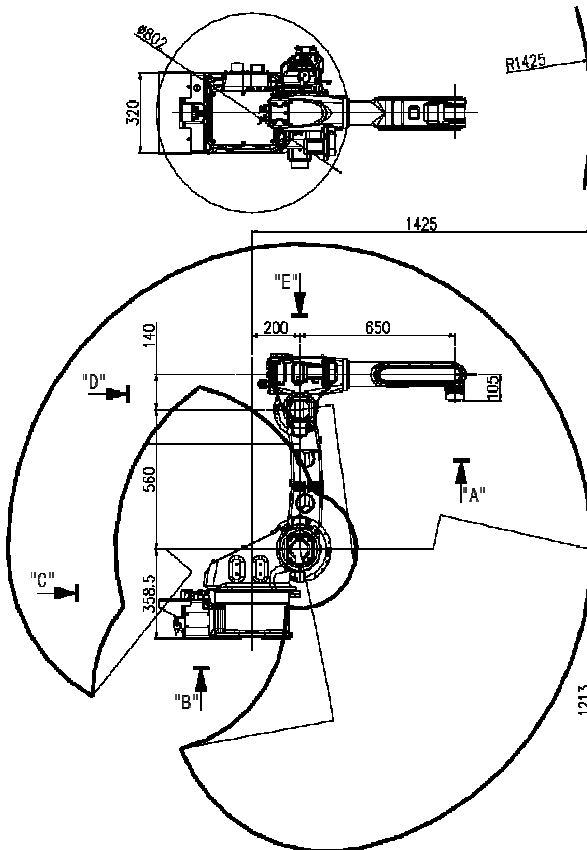

View A: Detailed drawing of the wrist

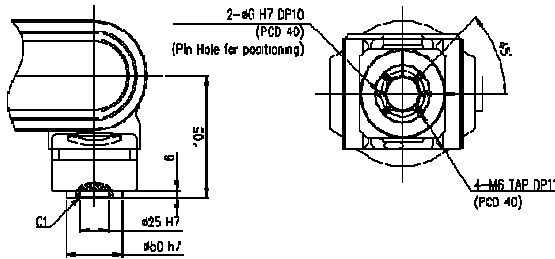

View B: Dimensional drawing for the floor installation of the

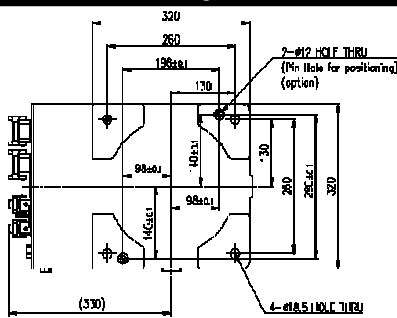

View C: Application cable connection part

View D: Application cable connection

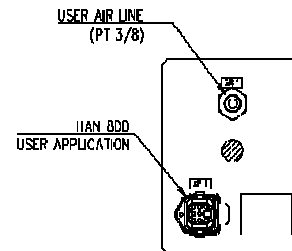

View E: Details of the application ancillary part

Wrist-axis torque line

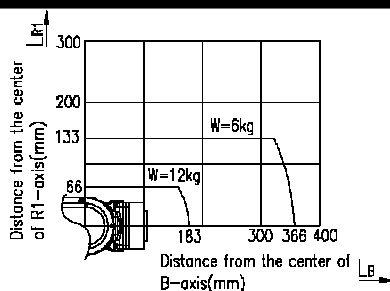

** For product improvement, some of the ratings, specifications, dimensions, etc. are subject to changes without notice.

Item		Specification
Robot model		HH012
Payload		12 Kg
Structure		Articulated
Degree of freedom		6 axes
Drive system		AC SERVO MOTOR
Max. working envelope	S Swivel	± 3.00 rad ($\pm 172^\circ$)
	H Horizontal	$+3.14 \sim -1.36$ rad ($+180^\circ \sim -78^\circ$)
	V Vertical	$+3.14 \sim -1.43$ rad ($+180^\circ \sim -82^\circ$)
	R2 Rotation 2	± 3.14 rad ($\pm 180^\circ$)
	B Bending	± 2.356 rad ($\pm 135^\circ$)
	R1 Rotation 1	± 6.283 rad ($\pm 360^\circ$)
Max. working speed	S Swivel	4.19 rad / s (240° / s)
	H Horizontal	4.01 rad / s (230° / s)
	V Vertical	4.01 rad / s (230° / s)
	R2 Rotation 2	7.75 rad / s (444° / s)
	B Bending	8.09 rad / s (464° / s)
	R1 Rotation 1	10.99 rad / s (630° / s)
Wrist torque	R2 Rotation 2	21.0 Nm (2.1 Kgfm)
	B Bending	21.0 Nm (2.1 Kgfm)
	R1 Rotation 1	7.8 Nm (0.8 Kgfm)
Accuracy of position repeatability		± 0.08 mm
Ambient Temperature		$0 \sim 45^\circ$ C ($273 \sim 318$ K)
Robot's Weight		145 Kg
Working envelope section area		3.16 m ²