

# HH020

**Payload 20 Kg**

Installation method		Application	
Floor	●	Spot welding	
Ceiling		Arc welding	●
Wall surface		Handling	●
		Assembly	
		Sealing	●
		Painting	

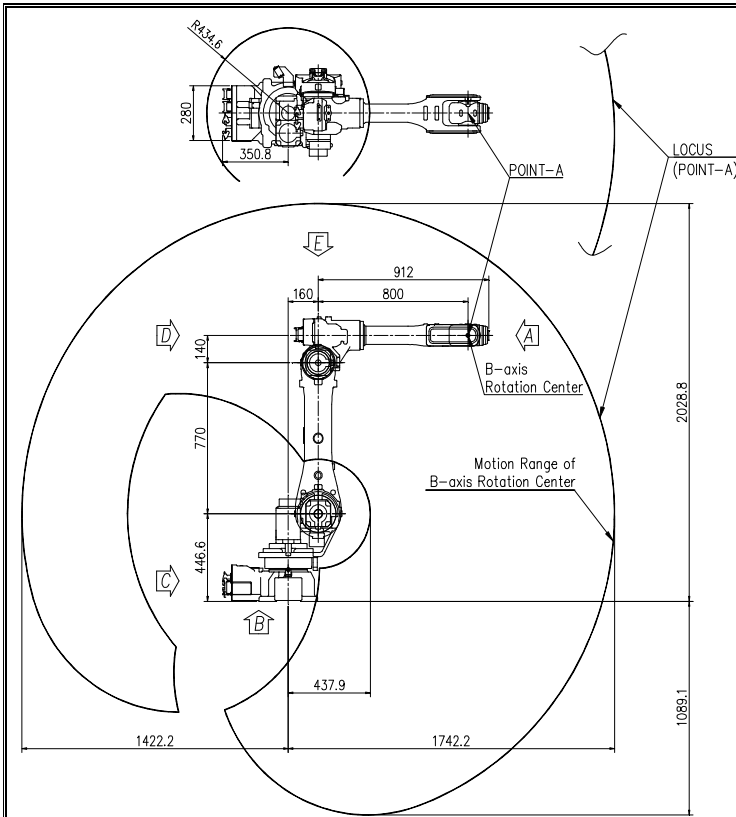

**View A: Detailed drawing of the wrist attachment part**

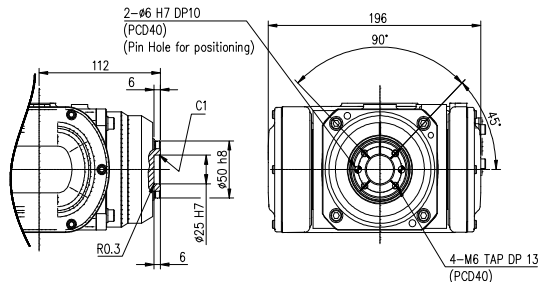

**View B: Dimensional drawing for the floor installation of the body**

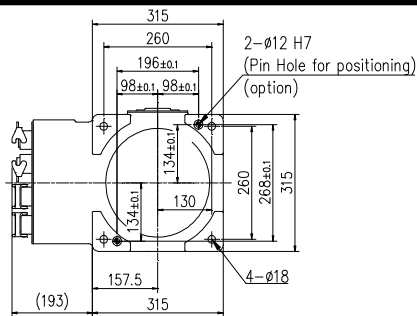

**View C: Application cable connection part (Option)**

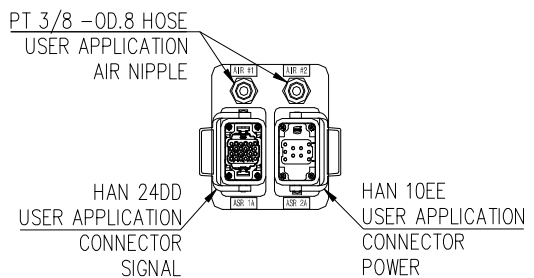

**View D: Application cable connection part (Option)**

**Wrist-axis torque line diagram**

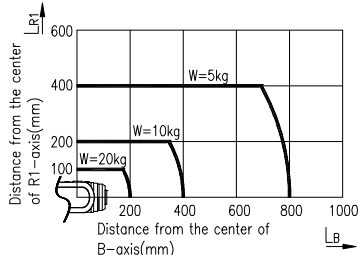

\*\* For product improvement, some of the ratings, specifications, dimensions, etc. are subject to changes without notice.

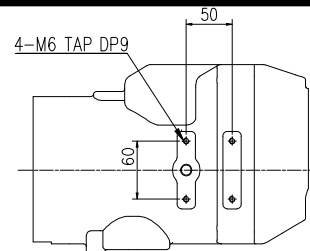

**View E: Details of the application ancillary part attachment**

Item		Specification		
Robot model		HH020		
Payload		20 Kg		
Structure		Articulated		
Degree of freedom		6 axes		
Drive system		AC SERVO MOTOR		
Max. working envelope	Arm	A	S Swivel	±3.229 rad (±185°)
		H	Horizontal	+3.403 ~ -1.222 rad (+195° ~ -70°)
		V	Vertical	+3.141 ~ -1.396 rad (+180° ~ -80°)
	Wrist	R2	Rotation 2	±3.403 rad (±195°)
		B	Bending	±2.356 rad (±135°)
		R1	Rotation 1	±6.283 rad (±360°)
Max. working speed	Arm	A	S Swivel	3.316 rad / s (190° / s)
		H	Horizontal	3.142 rad / s (180° / s)
		V	Vertical	3.316 rad / s (190° / s)
	Wrist	R2	Rotation 2	6.632 rad / s (380° / s)
		B	Bending	6.632 rad / s (380° / s)
		R1	Rotation 1	10.472 rad / s (600° / s)
Wrist torque	R2	Rotation 2	39.2 Nm (4 Kgfm)	
	B	Bending	39.2 Nm (4 Kgfm)	
	R1	Rotation 1	19.6 Nm (2 Kgfm)	
Accuracy of position repeatability		±0.08 mm		
Ambient Temperature		0 ~ 45 °C (273 ~ 318 K)		
Robot's Weight		225 Kg		
Working envelope section area		6.07 m <sup>2</sup>		